



MDL Insulations Ltd
 Villa Works, 1 Plant Lane Business Park
 Burntwood
 Staffordshire WS7 3GN
Tel: 01543 450311
Fax: 01543 450885
Email: sales@mdlinsulations.co.uk
Website: www.mdlinsulations.co.uk



FIREZERO THERMALZERO ACOUSTISOUNDZERO ACOUSTICFIREZERO VIBROZERO HYGENAZERO

25 mm RAINSCREEN FIRE CLOSER

PRODUCT DESCRIPTION

FIREZERO/RS/VENT Rain screen 25mm air gap fire closure consists of a carrier of high density mineral wool with a high volumetric expanding graphite intumescent facing strip laced on the side facing the airspace void in class 0 **FIREZERO**.

Two galvanised steel fixing straps are pre-fitted to the strip to prevent incorrect fixing.

PRODUCT FUNCTION

FIREZERO/RSH25/VENT is designed to go between the external rain screen cladding and the internal wall structure to create a fire break horizontally, normally at the floor beam/slab level. The product can also be used in the vertical plain at separating wall junctions to complete fire compartments where an air gap is required the brackets should be fixed alternatively to prevent slippage.

Generally an air gap is not needed vertically a **FIREZERO/RSV** fire stop can be used. This works under compression filling the vertical void creating an economical solution. Although fixed by compression brackets must be used.

The ECOSE rock core having a water vapour resistivity of 7.00 MN.s.g.m, being covered in Class 0 reinforced aluminium foil which is resistant to the passage of water/water vapour. Prevents water ingress.

ENVIRONMENT

Manufactured using new green **ECOSE™** Rock Mineral wool slab from Knauf Insulations helping reduce the carbon footprint. Knauf insulations new **ECOSE™** Technology Rock Slab.

This is the first organic binder Insulation product available in the UK. Rock slabs are free from CFCs, HCFCs and contain no other material elements with ozone depletion potential, thus they represent no known threat to the environment. Exceeding Breeam requirements and giving a classification of zero ODP and zero GWP. It is encapsulated in recycled plastic.

The product is intended to be used to help on eco projects where a low environmental impact is a key design consideration. The plastic sleeve is manufactured using recycled plastic

STANDARDS

MDL Insulations Ltd are accredited with ISO 14001 and ISO 9001 with a certificate no: 40007207 Our core mineral wool products are manufactured in accordance with BSI Quality Assurance Standard BS EN ISO 9001:2000 and Product Standard EN 13162 and CE marked and certified where appropriate.



FIREZERO

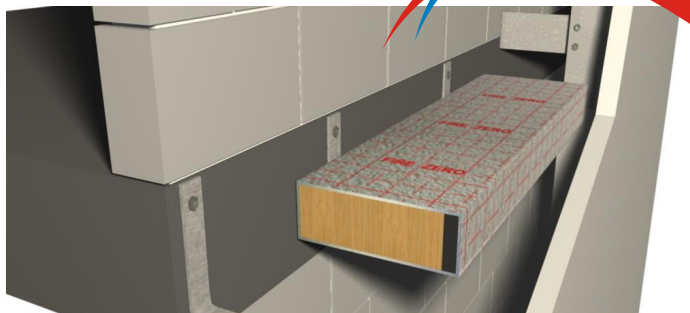

APPLICATION DETAIL

FIREZERO/RSH25/VENT horizontal fire stop should be fitted before the external rain screen but after the installation of the support framework. If insulation slabs are to be used they must be fitted after the product. The **FIREZERO/RSH25/VENT** must be fitted around all structural framework tightly; any joints or edges butting up to cuts or cut-outs around existing structures should also be sealed with **FIREZERO/IM/MASTIC** to ensure the continuation of the fire seal.

FIREZERO/RSH25/VENT must be fitted horizontally at floor beam level or ring beam level in timber frame application; if fitted onto a masonry wall the product should be in line with the internal floor slab. The correct fixings must be used to ensure compliance with fire testing and longevity of application. The two fixing straps per 1200mm length come pre-inserted if a length is cut then the straps must be reinserted at a minimum of 100mm from either end of the product (extra straps may be required).

TECHNICAL DATA

The mineral wool used to produce the core of this horizontal fire barrier is non combustibile to BS476 part 4 (1984). The correct use of the right horizontal **FIREZERO/RSH25/VENT** will provide 30, 60, 90, or 120 minutes of protection this is defined by the intumescent loading and the depth of the mineral wool carrier on the cavity barrier as defined in the approved document of the building regulations. It is of paramount importance to remember that the product will not add to the claddings own rating or that of the timber frame structure. The intumescent graphite used to close the structural air/water opening is water resistant and manufactured to meet BS EN 1363-1:1999 test CHILT/IF12007B (2012) when tested as a closure.

FIREZERO/RSH25/VENT is manufactured to give a 25mm air gap and is tailor made to fit the cavity width. We can manufacture to suite a cavity width from 25mm to 600mm and also make products to suit lower/higher airflow capacities of 10,000mm/sq or 45,000mm/sq. see data sheets 103, 106, 107. To enable the correct product to be supplied the basic information required is cavity size, face cladding, structure, number of storeys and rating required.

Data Sheet No: 1050 Issue : 07 Last Review: 29/01/2013

A data sheet is given as a guide only, results shown are obtained under test conditions and results may vary dependent to site conditions. It is the buyers responsibility to confirm suitability for their application with their designers. No responsibility for unsuitability will be accepted by MDL INSULATIONS LTD.