



MDL Insulations Ltd
 Villa Works, 1 Plant Lane Business Park
 Burntwood
 Staffordshire WS7 3GN
Tel: 01543 450311
Fax: 01543 450885
Email: sales@mdlinsulations.co.uk
Website: www.mdlinsulations.co.uk



FIREZERO THERMALZERO ACOUSTISOUNDZERO ACOUSTICFIREZERO VIBROZERO HYGENAZERO

FIREZERO STOPPING SERIES 5900

PRODUCT DESCRIPTION

FIREZERO WIDE STOPPING (Linear Gap Fire & Smoke Stop) consists of a length of Knauf Ecosse Mineral Wool slab which is cut and shaped with compression allowance to suit gaps of varying sizes and shapes of wide gaps over 300mm wide up to 600mm wide.

FIREZERO



PRODUCT FUNCTION

FIREZERO WIDE STOPPING strips prevent the spread of fire & smoke between compartments such as on top of masonry walls under soffits, between walls and steel work and between masonry & roofs.; above a partition system, as an expansion joint requiring a fire railing in a masonry wall within a metal cladding system and numerous similar applications.

FIREZERO WIDE STOPPING also aids the reduction of sound transmission. For gaps above 150mm deep use **FIREZERO Multi App Slab** (data sheet 728)

ENVIRONMENT

Manufactured using new green **ECOSE™** Rock Mineral wool slab from Knauf Insulations helping reduce the carbon footprint. Knauf insulations new **ECOSE™** Technology Rock Slab.

This is the first organic binder Insulation product available in the UK. Rock slabs are free from CFCs, HCFCs and contain no other material elements with ozone depletion potential, thus they represent no known threat to the environment. Exceeding Breeam requirements and giving a classification of zero ODP and zero GWP.

The product is intended to be used to help on eco projects where a low environmental impact is a key design consideration.

APPLICATION DETAIL

FIREZERO WIDES TOPPING strips must have a minimum compression of 2.5% (3mm minimum) when fitted to achieve the required rating. **FIREZERO STOPPING** is generally push fitted into an existing opening, and must be fitted correctly; any butt joints must be tight with no gaps. When fitting to masonry/concrete the rough nature of the surface can frustrate the fitter. To overcome this **FIREZERO WIDE STOPPING** can be fitted with a slip plate (ref: FZ/ST/SP/F) available from our stock, this is reusable and should always be removed.

When **FIREZERO WIDE STOPPING** is used to meet a fire requirement combining two components which may move and spate substantially during a fire, then these components must be secured together by a steel bracket to ensure the **FIREZERO WIDE STOPPING** does not fall out during a fire.

Various finishes can be applied to the **FIREZERO WIDE STOPPING** when fitted including plaster, mastic or foil and ablative coating for airtightness.

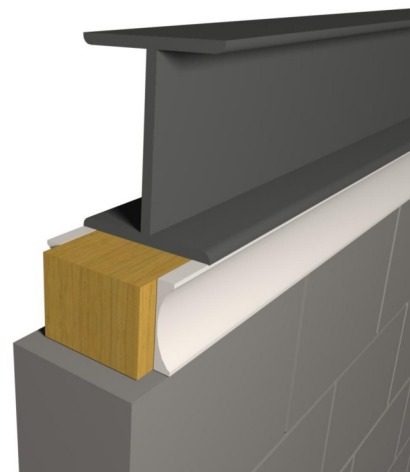

Showing with plaster coating applied

STANDARDS

MDL Insulations Ltd are accredited with ISO 14001 and ISO 9001 with a certificate no: 40007207 Our core mineral wool products are manufactured in accordance with BSI Quality Assurance Standard BS EN ISO 9001:2000 and Product Standard EN 13162 and CE marked and certified where appropriate.



Data Sheet No: 5900 (SERIES 5900) Issue : 01 Last Review: 15/05/2013

Due to our Policy of continual improvement the data given is for guidance only, results shown are obtained under test conditions and results may vary dependent to site conditions. It is the buyers responsibility to confirm suitability for their application with their designers. No responsibility for unsuitability will be accepted by MDL INSULATIONS LTD.



MDL Insulations Ltd
 Villa Works, 1 Plant Lane Business Park
 Burntwood
 Staffordshire WS7 3GN
Tel: 01543 450311
Fax: 01543 450885
Email: sales@mdlinsulations.co.uk
Website: www.mdlinsulations.co.uk



FIREZERO THERMALZERO ACOUSTISOUNDZERO ACOUSTICFIREZERO VIBROZERO HYGENAZERO

TECHNICAL DATA

The mineral wool used to produce **FIREZERO WIDE STOPPING** is classified non-combustible to BS476: part 4 (1984). **FIREZERO WIDE STOPPING** will achieve up to 240 minutes fire resistance to BS476: part 20 (1987) when tested in application 300mm wide achieves up to 120 minutes fire resistance, 400mm wide achieves up to 180 minutes fire resistance and 600mm wide achieves up to 240 minutes fire resistance.

A compression of 2.5% on the void must be added (a 3mm minimum applies). The products fire performance to BS476: part 20 (1987) is calculated to a maximum void size of 50% of the wall width. If higher than this then please contact our technical department for advise on correct product to suit. An acoustic performance which helps reduce the flanking transmission of sound through the filled void will occur; this will be dependant on the thickness and depth and the surrounding structure performances. Where used in conjunction with correct construction on party wall applications room to room sound reduction at the point of the **FIREZERO WIDE STOPPING** can achieve a significant reduction.

Ref	Length (mm)	Width (mm)	Depth (mm)	Ref	Length (mm)	Width (mm)	Depth (mm)
5900/12.5/300	1200	300	12.5	5900/55/400	1200	400	55
5900/15/300	1200	300	15	5900/60/400	1200	400	60
5900/20/300	1200	300	20	5900/65/400	1200	400	65
5900/25/300	1200	300	25	5900/70/400	1200	400	70
5900/30/300	1200	300	30	5900/75/400	1200	400	75
5900/40/300	1200	300	40	5900/80/400	1200	400	80
5900/45/300	1200	300	45	5900/90/300	1200	300	90
5900/50/300	1200	300	50	5900/100/300	1200	300	100
5900/55/300	1200	300	55	5900/12.5/600	1200	600	12.5
5900/60/300	1200	300	60	5900/15/600	1200	600	15
5900/65/300	1200	300	65	5900/20/600	1200	600	20
5900/70/300	1200	300	70	5900/25/600	1200	600	25
5900/75/300	1200	300	75	5900/30/600	1200	600	30
5900/80/300	1200	300	80	5900/40/600	1200	600	40
5900/90/300	1200	300	90	5900/45/600	1200	600	45
5900/100/300	1200	300	100	5900/50/600	1200	600	50
5900/12.5/400	1200	400	12.5	5900/55/600	1200	600	55
5900/15/400	1200	400	15	5900/60/600	1200	600	60
5900/20/400	1200	400	20	5900/65/600	1200	600	65
5900/25/400	1200	400	25	5900/70/600	1200	600	70
5900/30/400	1200	400	30	5900/75/600	1200	600	75
5900/40/400	1200	400	40	5900/80/600	1200	600	80
5900/45/400	1200	400	45	5900/90/600	1200	600	90
5900/50/400	1200	400	50	5900/100/600	1200	600	100

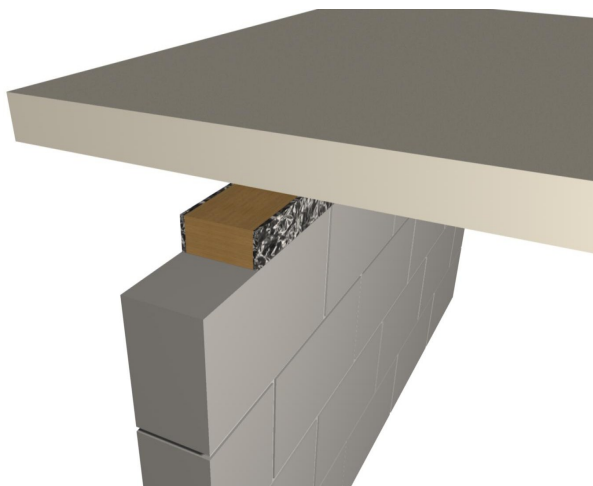

Foil Faced (2 sides)

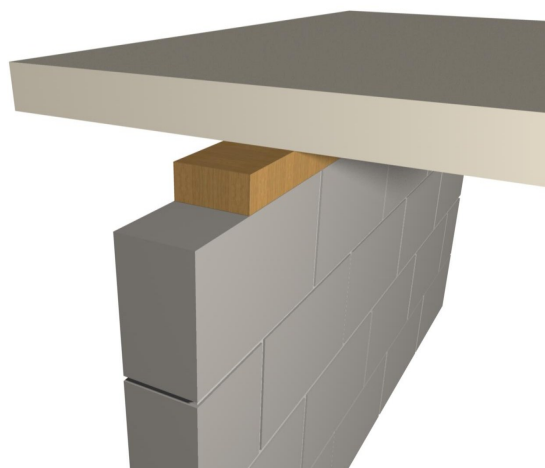

Plain