



MDL Insulations Ltd
 Villa Works, 1 Plant Lane Business Park
 Burntwood
 Staffordshire WS7 3GN
Tel: 01543 450311
Fax: 01543 450885
Email: sales@mdlinsulations.co.uk
Website: www.mdlinsulations.co.uk



FIREZERO THERMALZERO ACOUSTISOUNDZERO ACOUSTICFIREZERO VIBROZERO HYGENAZERO

FIREZERO STOPPING SERIES 5800

FIREZERO

PRODUCT DESCRIPTION

FIREZERO STOPPING (Linear Gap Fire & Smoke Stop) consists of a length of Knauf Ecosse Mineral Wool slab which is cut and shaped with compression allowance to suit gaps of varying sizes and shapes.



PRODUCT FUNCTION

FIREZERO STOPPING strips prevent the spread of fire & smoke between compartments such as on top of masonry walls under soffits, between walls and steel work and between masonry & roofs.; above a partition system, as an expansion joint requiring a fire railing in a masonry wall within a metal cladding system and numerous similar applications.

FIREZERO STOPPING also aids the reduction of sound transmission. For gaps above 150mm deep use **FIREZERO Multi App Slab** (data sheet 728)

APPLICATION DETAIL

FIREZERO STOPPING strips must have a minimum compression of 2.5% (3mm minimum) when fitted to achieve the required rating. **FIREZERO STOPPING** is generally push fitted into an existing opening, and must be fitted correctly; any butt joints must be tight with no gaps. When fitting to masonry/concrete the rough nature of the surface can frustrate the fitter. To overcome this **FIREZERO STOPPING** can be fitted with a slip plate (ref: FZ/ST/SP/F) available from our stock, this is reusable and should always be removed.

ENVIRONMENT

Manufactured using new green **ECOSE™** Rock Mineral wool slab from Knauf Insulations helping reduce the carbon footprint. Knauf insulations new **ECOSE™** Technology Rock Slab.

This is the first organic binder Insulation product available in the UK. Rock slabs are free from CFCs, HCFCs and contain no other material elements with ozone depletion potential, thus they represent no known threat to the environment. Exceeding Breeam requirements and giving a classification of zero ODP and zero GWP.

The product is intended to be used to help on eco projects where a low environmental impact is a key design consideration.

When **FIREZERO STOPPING** is used to meet a fire requirement combining two components which may move and spate substantially during a fire, then these components must be secured together by a steel bracket to ensure the **FIREZERO STOPPING** does not fall out during a fire.

Various finishes can be applied to the **FIREZERO STOPPING** when fitted including plaster, mastic or foil.

STANDARDS

MDL Insulations Ltd are accredited with ISO 14001 and ISO 9001 with a certificate no: 40007207 Our core mineral wool products are manufactured in accordance with BSI Quality Assurance Standard BS EN ISO 9001:2000 and Product Standard EN 13162 and CE marked and certified where appropriate.

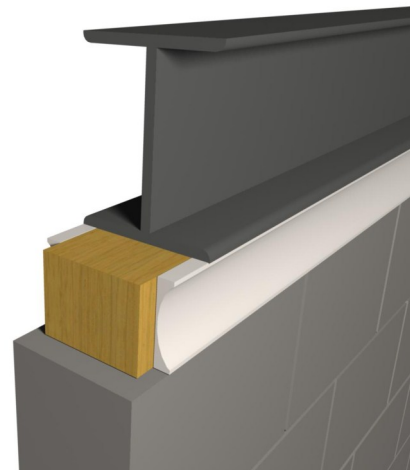

Showing with plaster coating applied



MDL Insulations Ltd
 Villa Works, 1 Plant Lane Business Park
 Burntwood
 Staffordshire WS7 3GN
Tel: 01543 450311
Fax: 01543 450885
Email: sales@mdlinsulations.co.uk
Website: www.mdlinsulations.co.uk



FIREZERO THERMALZERO ACOUSTISOUNDZERO ACOUSTICFIREZERO VIBROZERO HYGENAZERO

TECHNICAL DATA

The mineral wool used to produce **FIREZERO STOPPING** is classified non-combustible to BS476: part 4 (1984). **FIREZERO STOPPING** will achieve up to 240 minutes fire resistance to BS476: part 20 (1987) when tested in application 100mm wide achieves up to 120 minutes fire resistance, 150mm wide achieves up to 180 minutes fire resistance and 200mm wide achieves up to 240 minutes fire resistance.

A compression of 2.5% on the void must be added (a 3mm minimum applies). The products fire performance to BS476: part 20 (1987) is calculated to a maximum void size of 50% of the wall width. If higher than this then please contact our technical department for advise on correct product to suit. An acoustic performance which helps reduce the flanking transmission of sound through the filled void will occur; this will be dependant on the thickness and depth and the surrounding structure performances. Where used in conjunction with correct construction on party wall applications room to room sound reduction at the point of the **FIREZERO STOPPING** can achieve a significant reduction.

Ref	Length (mm)	Width (mm)	Depth (mm)	Ref	Length (mm)	Width (mm)	Depth (mm)
FZ/STOP/12.5/100	1200	100	12.5	FZ/STOP/55/150	1200	150	55
FZ/STOP/15/100	1200	100	15	FZ/STOP/60/150	1200	150	60
FZ/STOP/20/100	1200	100	20	FZ/STOP/65/150	1200	150	65
FZ/STOP/25/100	1200	100	25	FZ/STOP/70/150	1200	150	70
FZ/STOP/30/100	1200	100	30	FZ/STOP/75/150	1200	150	75
FZ/STOP/40/100	1200	100	40	FZ/STOP/80/150	1200	150	80
FZ/STOP/45/100	1200	100	45	FZ/STOP/90/100	1200	150	90
FZ/STOP/50/100	1200	100	50	FZ/STOP/100/100	1200	150	100
FZ/STOP/55/100	1200	100	55	FZ/STOP/12.5/200	1200	200	12.5
FZ/STOP/60/100	1200	100	60	FZ/STOP/15/200	1200	200	15
FZ/STOP/65/100	1200	100	65	FZ/STOP/20/200	1200	200	20
FZ/STOP/70/100	1200	100	70	FZ/STOP/25/200	1200	200	25
FZ/STOP/75/100	1200	100	75	FZ/STOP/30/200	1200	200	30
FZ/STOP/80/100	1200	100	80	FZ/STOP/40/200	1200	200	40
FZ/STOP/90/100	1200	100	90	FZ/STOP/45/200	1200	200	45
FZ/STOP/100/100	1200	100	100	FZ/STOP/50/200	1200	200	50
FZ/STOP/12.5/150	1200	150	12.5	FZ/STOP/55/200	1200	200	55
FZ/STOP/15/150	1200	150	15	FZ/STOP/60/200	1200	200	60
FZ/STOP/20/150	1200	150	20	FZ/STOP/65/200	1200	200	65
FZ/STOP/25/150	1200	150	25	FZ/STOP/70/200	1200	200	70
FZ/STOP/30/150	1200	150	30	FZ/STOP/75/200	1200	200	75
FZ/STOP/40/150	1200	150	40	FZ/STOP/80/200	1200	200	80
FZ/STOP/45/150	1200	150	45	FZ/STOP/90/200	1200	200	90
FZ/STOP/50/150	1200	150	50	FZ/STOP/100/200	1200	200	100

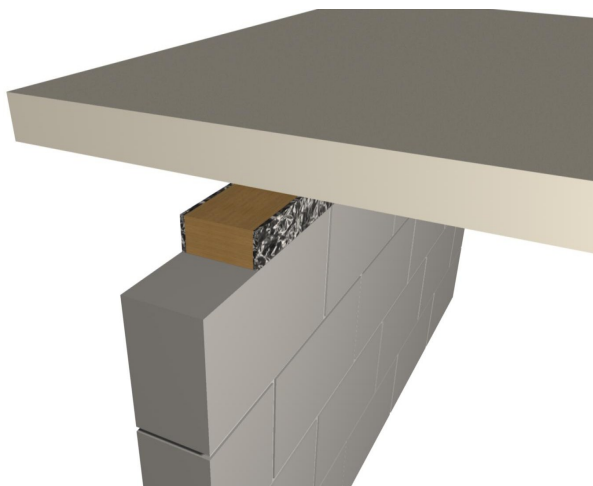

Foil Faced (2 sides)

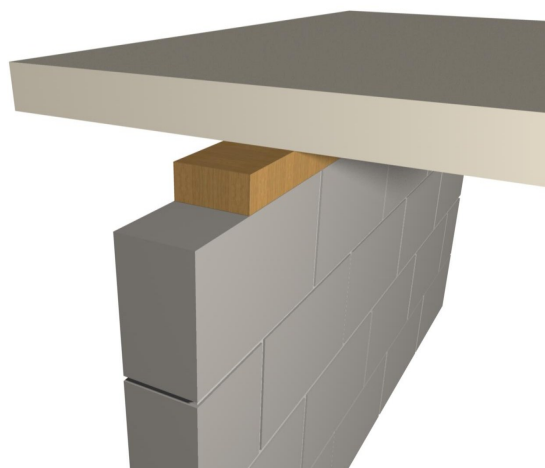

Plain