



MDL Insulations Ltd
 Villa Works, 1 Plant Lane Business Park
 Burntwood
 Staffordshire WS7 3GN
Tel: 01543 337311
Fax: 01543 337885
Email: sales@mdlinsulations.co.uk
Website: www.mdlinsulations.co.uk



FIREZERO THERMALZERO ACOUSTISOUNDZERO ACOUSTICFIREZERO VIBROZERO HYGENAZERO

FIREZERO



FIREZERO SERIES 2500

PRODUCT DESCRIPTION

SERIES 2500 is MDL **FIREZERO-DPC** Fire & Acoustic Party Wall DPC consists of a length of semi rigid **ECOSE™** mineral wool slab by Knauf Insulations which is fully encapsulated in a micro perforated orange sleeve manufactured from recycled materials, printed with current regulations and fire certification to aid visual site identification and guarantees authenticity. Suitable for all applications against external Brick/Block, rain screen, render or metal claddings.

APPLICATION DETAIL

FIREZERO-DPC Fire & Acoustic Party Wall DPC should be fitted during the external work stage of the building process. The product must be fitted in the cavity with the DPC face against the inside of the outer brickwork with the 40mm flanges on both sides. During a vertical application each length must be fitted with the 100mm flange at the bottom, so that the next length when forming a close butt joint over the flange continues the DPC barrier. For horizontal applications **FIREZERO—LEVEL** should be used as it forms a cavity tray between the inner and outer leaf (see data sheet 27).

ENVIRONMENT

Manufactured using new green **ECOSE™** Rock Mineral wool slab from Knauf Insulations helping reduce the carbon footprint. Knauf insulations new **ECOSE™** Technology Rock Slab.

This is the first organic binder Insulation product available in the UK. Rock slabs are free from CFCs, HCFCs and contain no other material elements with ozone depletion potential, thus they represent no known threat to the environment. Exceeding Breeam requirements and giving a classification of zero ODP and zero GWP. It is encapsulated in recycled plastic.

The product is intended to be used to help on eco projects where a low environmental impact is a key design consideration. The plastic sleeve is manufactured using recycled plastic.

STANDARDS

MDL Insulations Ltd are accredited with ISO 14001 and ISO 9001 with a certificate no: 40007207 Our core mineral wool products are manufactured in accordance with BSI Quality Assurance Standard BS EN ISO 9001:2000 and Product Standard EN 13162 and CE marked and certified where appropriate.



PRODUCT FUNCTION

FIREZERO-DPC Fire & Acoustic Party Wall DPC is designed to Prevent fire penetration and significantly aid the reduction of sound transmission through the cavity of the external party walls and separating floors whilst preventing water tracking from the outer leaf of the building to the inner leaf.

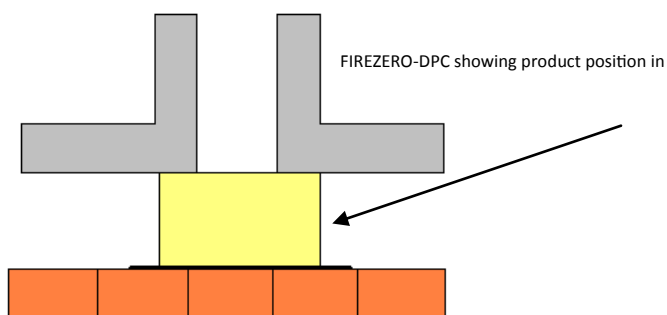



MDL Insulations Ltd
 Villa Works, 1 Plant Lane Business Park
 Burntwood
 Staffordshire WS7 3GN
Tel: 01543 337311
Fax: 01543 337885
Email: sales@mdlinsulations.co.uk
Website: www.mdlinsulations.co.uk



FIREZERO THERMALZERO ACOUSTICSOUNDZERO ACOUSTICFIREZERO VIBROZERO HYGENAZERO

TECHNICAL DATA

FIREZERO-DPC Fire and Acoustic Party Wall DPC is produced using non-combustible mineral wool which conforms to BS476 (part 4: (1984).

The correct application of this product will exceed the 30 minute cavity fire barrier requirement as defined in the Building Regulations 1991 (Table A1 of Appendix A to Approved Document B). Our products have been independently tested by Chiltern International Fire where the test was stopped after 66 minutes giving the **FIREZERO-DPC** a fire protection rating in excess of 1 hour. Our product testing has been carried out both vertically and horizontally by Chiltern International Fire who provided test certification **CHILT/IF06028** showing vertical applications and **CHILT/IF06027** showing horizontal applications.

Approved document B of the Building Regulations 1991 (2000 edition), Section 10 Table 12 "Provision of Cavity Barriers" gives a complete list of cavity type and building purpose groups for which a cavity barrier should be installed. Table 14 of the same document gives maximum dimensions of cavities in specified building groups. These tables should be referred to in full by the designer when considering the provision of cavity barriers.

To achieve the 30 minute fire rating required within current building regulations when installed in the external cavity wall **FIREZERO-DPC** should have an equal overlap to each side of the party wall opening cavity of at least 50mm. for a 60 minute fire rating then an equal overlap of at least 75mm is required. **FIREZERO-DPC** Acoustic Party Wall DPC comply with the robust details accepted to prove a solution which satisfies the Approved Document E (2003 edition) of the Building Regulations relating to the transmission of sound.

To order **FIREZERO-DPC** corners just place the letters 'CC/' in front of the above standard product reference.

HANDLING

FIREZERO-DPC Acoustic A/F Party Wall DPC is packed in polyethylene bags for on site protection. Care should be taken to keep the product dry prior to installation. Some local delamination may occur during handling. This does not detract from the performance of the product when fitted.

*Many more **FIRE ACOUSTIC & THERMAL** products available*

Product Ref	Product Length (mm)	DPC Length (mm)	DPC Minimum Width (mm)	To suit cavity width (mm)	Quantity per Pack
2500/50/337	1200	1300	337	50	10
2500/60/337	1200	1300	337	60	10
2500/65/337	1200	1300	337	65	8
2500/75/337	1200	1300	337	75	8
2500/80/337	1200	1300	337	80	8
2500/85/337	1200	1300	337	85	6
2500/90/337	1200	1300	337	90	6
2500/95/337	1200	1300	337	95	6
2500/100/337	1200	1300	337	100	6
2500/110/337	1200	1300	337	110	6
2500/115/337	1200	1300	337	115	6
2500/120/337	1200	1300	337	120	4
2500/125/337	1200	1300	337	125	4
2500/130/337	1200	1300	337	130	4
2500/135/337	1200	1300	337	135	4
2500/140/337	1200	1300	337	140	4
2500/145/337	1200	1300	337	145	4
2500/150/337	1200	1300	337	150	4

We can also manufacture **FIREZERO-DPC** to suit other cavity thicknesses as well as with any other insulation and DPC width to suit special requirements. **Products can be made for up to 300mm cavity size**

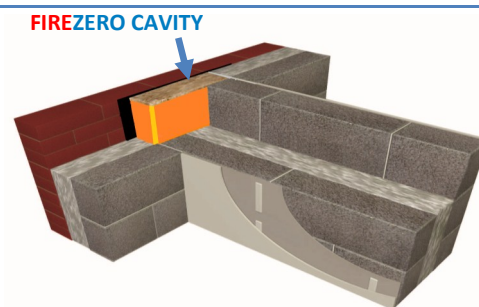

Typical Party Wall (Masonry) Application

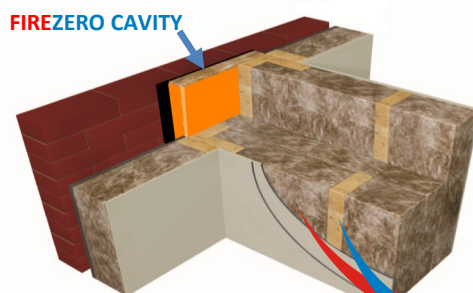

Typical Party Wall (Timber Frame) Application

THERMAL FIREZERO